

## DC SPUR GEAR MOTOR DM-65SS3530

典型应用/Typical applications :  
自动快锁门、装订机、自动电视架、点钞机、聚光灯、卫生纸机、  
办公设备、家用电器、自动执行机构  
Auto shutter, binding machine, automatic TV rack, money counter,  
spotlight, tissue machine, office equipments, household appliances,  
automatic actuator

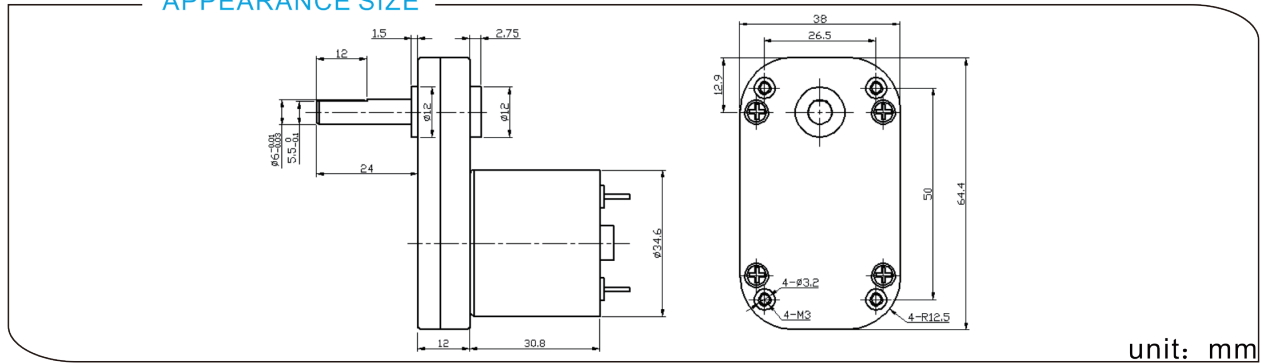

### APPEARANCE SIZE



unit: mm

### 齿轮箱参数/Gearbox Data:

级数 Number of stages	3	4	5
减数比 Reduction Ratio i	40.5、67.5	135、152、225	450
齿轮箱长度 Gearbox Length L (mm)	12	12	12
破坏扭力 Breaking Torque(kgf.cm)	10	25	35
齿轮箱效率 Gearbox Efficiency η	73%	65%	59%

### 电机参数/Driving Motor Data:

DC Motor Model	Rated	No Load		Max Efficiency Load				Stall	
	电压	电流	转速	电流	转速 (nm)	扭矩 (tm)	率功	扭矩	电流
	Volt.	Current	Speed	Current	Speed	Torque)	P.out	Torque	Current
	V	mA	r/min	mA	r/min	gf.cm	W	gf.cm	mA
DM-3530-012-3000	12	≤40	3000	≤240	2200	40	0.9	≥160	≥700
DM-3530-012-4500	12	≤60	4500	≤450	3300	50	1.7	≥300	≥1400
DM-3530-012-6000	12	≤90	6000	≤700	4500	60	2.8	≥350	≥2000
DM-3530-024-3000	24	≤20	3000	≤150	2200	40	0.9	≥160	≥400
DM-3530-024-4500	24	≤30	4500	≤230	3300	50	1.7	≥220	≥600

### 减数电机参数/Geared Motor Data :

Gear Motor Model	额定电压 Rated voltage	No load		Max Efficiency Load				Stall	
		电流	转速	电流	转速 (n)	扭矩 (t)	率功	扭矩	电流
		Current	Speed	Current	Speed	Torque	P.out	Torque	Current
	V	A	r/min	A	r/min	kgf.cm	W	kgf.cm	A
DM-65SS3530-0123000-135K	12	0.02	20.5	0.1	17.5	3.0	0.53	20.0	0.58
DM-65SS3530-0123000-125K	12	0.02	18.8	0.1	15.9	3.1	0.51	20.0	0.54
DM-65SS3530-0124500-135K	12	0.04	33.5	0.22	29	4.4	1.3	30.0	1.39
DM-65SS3530-0124500-152K	12	0.04	29.6	0.22	25.1	4.8	1.23	31.1	1.22
DM-65SS3530-0124500-225K	12	0.04	19.2	0.24	16.5	7.0	1.27	54.0	1.49

电机参数仅供参考, 请以实际样板为准; 可以依据客户要求定制参数。

The motor parameters are for reference only, please refer to real measured data;

We can customize parameters according to customer requirements.

减数电机输出转速=直流电机输出转速/齿轮箱减数比; 减数电机输出扭矩=直流电机输出扭矩\*齿轮箱减数比\*齿轮箱传动效率。

Gear Motor Output Speed=DC Motor Speed/Gear Ratio (n=n<sub>m</sub>/i)

Gear Motor Output Torque=DC Motor Torque\*Gear Ratio\*Gearbox Efficiency. (t=t<sub>m</sub>\*i\*η)