

DC SPUR GEAR MOTOR DM-70SS3540

典型应用/Typical applications :

自动快锁门、装订机、自动电视架、点钞机、聚光灯、卫生纸机、
办公设备、家用电器、自动执行机构

Auto shutter, binding machine, automatic TV rack, money counter,
spotlight, tissue machine, office equipments, household appliances,
automatic actuator



APPEARANCE SIZE

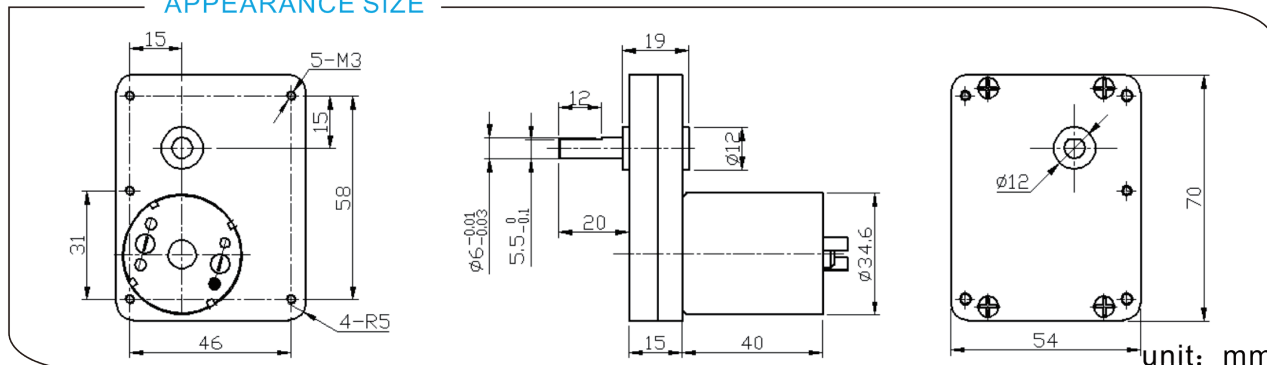

齿轮箱参数/Gearbox Data:

级数 Number of stages	3	4	5
减数比 Reduction Ratio i	54、73	217、293	564、763
齿轮箱长度 Gearbox Length L (mm)	15	15	15
破坏扭力 Breaking Torque(kgf.cm)	25	35	40
齿轮箱效率 Gearbox Efficiency η	73%	65%	59%

电机参数/Driving Motor Data:

DC Motor Model	Rated	No Load		Max Efficiency Load			Stall		
	电压	电流	转速	电流	转速 (nm)	扭矩 (tm)	率功	扭矩	电流
	Volt.	Current	Speed	Current	Speed	Torque	P.out	Torque	Current
	V	mA	r/min	mA	r/min	gf.cm	W	gf.cm	mA
DM-3540-012-3000	12	≤50	3000	≤300	2200	60	1.4	≥240	≥800
DM-3540-012-4500	12	≤70	4500	≤500	3300	70	2.4	≥500	≥2000
DM-3540-012-6000	12	≤100	6000	≤700	4500	80	3.7	≥600	≥2500
DM-3540-024-3000	24	≤25	3000	≤150	2200	60	1.4	≥220	≥500
DM-3540-024-4500	24	≤35	4500	≤250	3300	70	2.4	≥240	≥800

减数电机参数/Geared Motor Data :

Gear Motor Model	额定电压 Rated voltage	No load		Max Efficiency Load			Stall		
		电流	转速	电流	转速 (n)	扭矩 (t)	率功	扭矩	电流
		Current	Speed	Current	Speed	Torque	P.out	Torque	Current
	V	A	r/min	A	r/min	kgf.cm	W	kgf.cm	A
DM-70SS3540-0064800-73K	6	0.16	66.1	0.84	53.4	3.9	2.16	20.5	3.65
DM-70SS3540-0125000-763K	12	0.15	6.4	0.46	5.1	34.2	1.78	160	1.67
DM-70SS3540-0129500-564K	12	0.37	14.8	1.3	11.2	45.0	5.28	187.1	4.36
DM-70SS3540-0243000-217K	24	0.02	12.7	0.09	10.2	8.5	0.89	43.6	0.39

电机参数仅供参考, 请以实际样板为准; 可以依据客户要求定制参数。

The motor parameters are for reference only, please refer to real measured data;

We can customize parameters according to customer requirements.

减数电机输出转速=直流电机输出转速/齿轮箱减数比; 减数电机输出扭矩=直流电机输出扭矩*齿轮箱减数比*齿轮箱传动效率。

Gear Motor Output Speed=DC Motor Speed/Gear Ratio (n=n_m/i)

Gear Motor Output Torque=DC Motor Torque*Gear Ratio*Gearbox Efficiency. (t=t_m*i*η)