

DC SPUR GEAR MOTOR DM-33RS395

典型应用/Typical applications :
自动快锁门、装订机、自动电视架、点钞机、聚光灯、卫生纸机、
办公设备、家用电器、自动执行机构
Auto shutter, binding machine, automatic TV rack, money counter,
spotlight, tissue machine, office equipments, household appliances,
automatic actuator

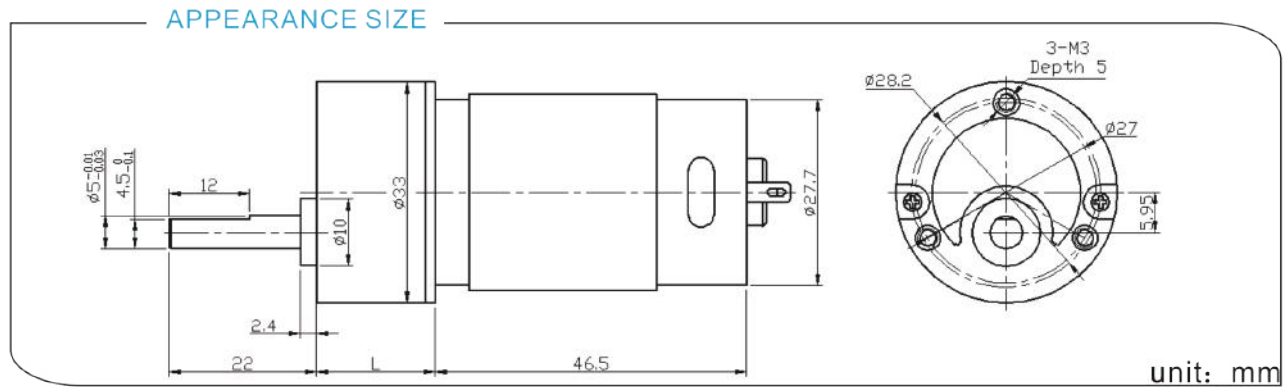

齿轮箱参数/Gearbox Data:

级数 Number of stages	3	4	5	6	7
减数比 Reduction Ratio i	20	50	125	312.5	781
齿轮箱长度 Gearbox Length L (mm)	17.7	19.9	22.2	24.4	26.75
破坏扭力 Breaking Torque(kgf.cm)	10	15	20	24	24
齿轮箱效率 Gearbox Efficiency η	73%	65%	59%	53%	48%

电机参数/Driving Motor Data:

DC Motor Model	Rated	No Load		Max Efficiency Load				Stall	
	电压	电流	转速	电流	转速 (nm)	扭矩 (tm)	功率	扭矩	电流
	Volt.	Current	Speed	Current	Speed	Torque	P.out	Torque	Current
DM-395-012-3000	12	≤60	3000	≤250	2200	65	1.5	≥110	≥360
DM-395-012-4500	12	≤90	4500	≤430	3300	80	2.7	≥210	≥960
DM-395-012-6000	12	≤130	6000	≤750	4800	100	4.9	≥280	≥1600
DM-395-024-3000	24	≤40	3000	≤120	2200	65	1.5	≥110	≥160
DM-395-024-4500	24	≤60	4500	≤220	3300	80	2.7	≥180	≥380

减数电机参数/Geared Motor Data :

Gear Motor Model	额定电压 Rated voltage	No load		Max Efficiency Load				Stall	
		电流	转速	电流	转速 (n)	扭矩 (t)	功率	扭矩	电流
		Current	Speed	Current	Speed	Torque	P.out	Torque	Current
DM-33RS395-0124500-174K	12	0.09	26.8	0.46	21.9	8.5	1.91	46.2	2.11
DM-33RS395-0127600-90K	12	0.17	85.7	0.8	70.0	5.0	4.1	31.0	3.6
DM-33RS395-0246000-312.5K	24	0.08	20.4	0.38	16.5	16.9	2.86	88.0	1.66

电机参数仅供参考, 请以实际样板为准; 可以依据客户要求定制参数。

The motor parameters are for reference only, please refer to real measured data;

We can customize parameters according to customer requirements.

减数电机输出转速=直流电机输出转速/齿轮箱减数比; 减数电机输出扭矩=直流电机输出扭矩*齿轮箱减数比*齿轮箱传动效率。

Gear Motor Output Speed=DC Motor Speed/Gear Ratio ($n=n_m/i$)

Gear Motor Output Torque=DC Motor Torque*Gear Ratio*Gearbox Efficiency. ($t=t_m*i*\eta$)